

Courses & distances from
the Elm down the river

- N 45 W 51 LOCUST
- N 76 W 42 Post
- N 54 W 56 Hickory
- N 39 W 22 Post
- N 2 W 31 Hickory
- N 13 E 61 Post
- N 52 E 38 Post
- N 67 E 24 Post
- S 45 E 27 1/2 Mulberry
- S 21 E 16 Post
- S 55 E 17 Post
- S 71 E 11 Post
- N 54 E 81 Post & Beginning

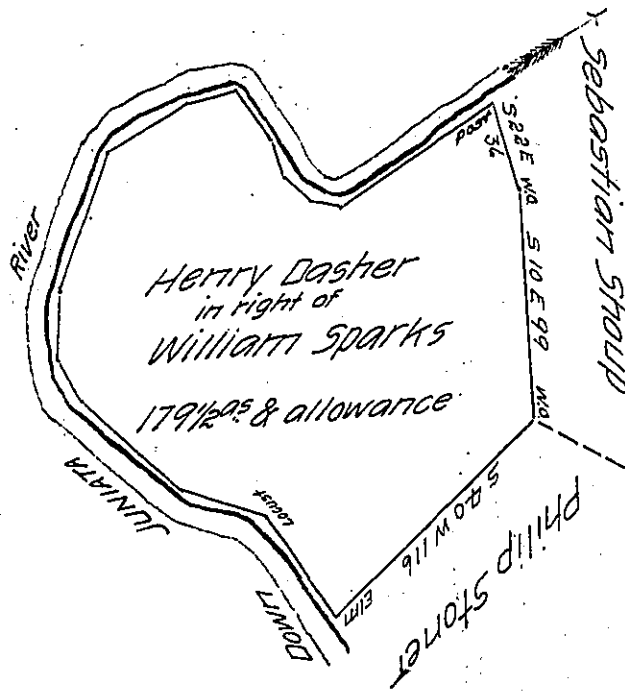

Situate on the Juniata River in Hopewell Township Bedford County
containing 179 1/2 acres and allowance of six P cent &c originally surveyed
for William Sparks on order N^o 2705 resurveyed for Henry Dasher the 12th day
of June 1809 on order of resurvey granted by the board of property dated
the 21st day of March 1809

P^r. W^m. Piper D. S.

Examined the 18th day of March 1835 by me
To Jacob Spangler Esq^r. S. G.

Robert Stuart D. S.

IN TESTIMONY that the above is a copy of the original remaining on file in
the Department of Internal Affairs of Pennsylvania, made
conformably to an Act of Assembly approved the 16th day of
February, 1833, I have hereunto set my Hand and caused
the Seal of said Department to be affixed at Harrisburg,
this twenty first day of December 1906

Lauren Brown
Secretary of Internal Affairs.